

Ulstein Aquamaster™

Azimuthing thrusters, type US 55-305 FP, CP or CRP

Features

Mounting options

- Bottom well cover type.
All components are mounted on the bottom well cover. The unit is lowered inside the hull and bolted in place. See 'Main dimensions' drawing.
- Weld-in type as in 'Propeller types' picture.

Hydraulic pump options

- V-belt-drive from drive shaft
- Driven from PTO
- Driven by separate electric motor

Contra rotating propeller (CRP) is an propeller option

- Vibration free
- Low noise
- Highest fuel economy

Steering gear drive options

- Hydraulic motors
- Electric motors with frequency converters

Clutch

- Clutch is multidisc type mounted on the input shaft and hydraulically operated. For smallest units the clutch is cone type mounted on the input shaft and hydraulically operated
- 'On-off' type clutch is standard for diesel engine use.
- Optional 'slipping type' clutch for 105-305 units provides the smooth control for propeller speed at the engine idling speed.

Intermediate shaft arrangement

- Standard shaft arrangement for direct diesel drive is complete assembly with two cardan shafts, support bearings, solid shaft, watertight bulkhead sealing etc.
- Optionally other shafting arrangements are available.

Back-stop option

- Back-stop device is available for 105-305 units and prevents reverse rotation of propeller

Main dimensions

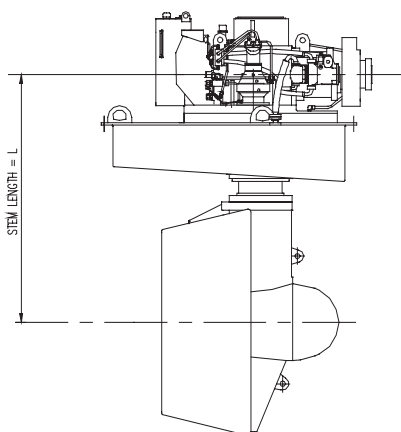

Propeller types

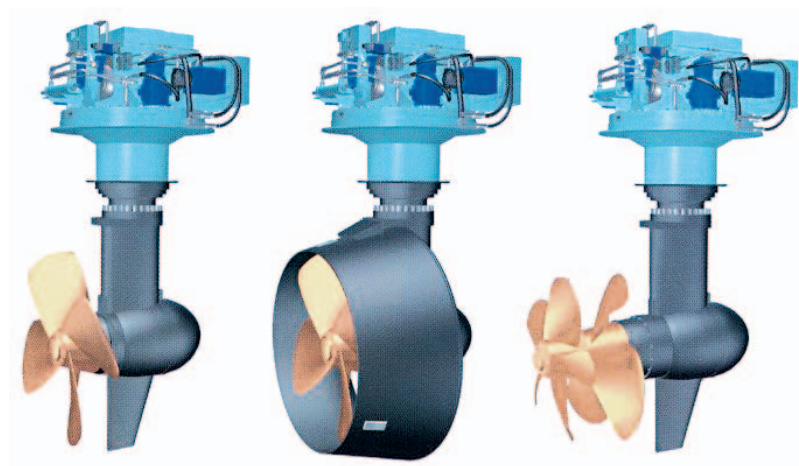

Open propeller

Ducted propeller

CRP-propeller

Fact Sheet

Technical data

US 55	Ducted FP propeller		Open propeller		CRP
Propeller diameter (mm)	1 050		Max. 1 250		Max. 1 250
L, nominal stem length (mm)	1 500		1 500		1 500
Weight, dry (kg)*	1 850		1 500		1 800
Nominal input speed	1500-2100 rpm				1 500-2 100 rpm
Nominal input power **	Max. 330 kW				Max. 280 kW
Bollard pull range	Up to 10.5 metric tons per two (2) units				-

US 105	Ducted FP propeller			Open propeller		CRP	
Propeller diameter (mm)	1 300	1 500	1 600	Max. 1 400	Max. 1 800	Max. 1 500	Max. 1 700
L, nominal stem length (mm)	1 850	2 400	2 400	1 850	2 400	1 750	2 300
Weight, dry (kg)*	4 700	5 900	5 990	4 000	5 150	3 300	5 800
Nominal input speed	1 500-1 800 rpm	750-2 000 rpm		1 500-1 800 rpm	750-2 000 rpm	1 500-1 800 rpm	1 000-1 800 rpm
Nominal input power **	Max. 500 kW	Max. 700 kW		Max. 500 kW	Max. 700 kW	Max. 440 kW	Max. 660 kW
Bollard pull range	Up to 23 metric tons per two (2) units					-	

US 155	Ducted FP/CP propeller				Open propeller		CRP	
Propeller diameter (mm)	1 600	1 800	1 800	2 000	Max. 2 100	Max. 2 300	Max. 2 100	Max. 2 300
L, nominal stem length (mm)	2 370	2 500	2 500/2 560	2 620/2 680	9 500	10 500		2 870
Weight, dry (kg)*	9 440	10 800	11 800	12 500	9 500	11 000	12 000	13 500
Nominal input speed	750-2 000 rpm				750-1 800 rpm			
Nominal input power **	Max. 960 kW		Max. 1 145 kW		Max. 960 kW	Max. 1 145 kW	Max. 960 kW	Max. 1 145 kW
Bollard pull range	Up to 30 metric tons per two (2) units						-	

US 175	Ducted FP/CP propeller			Open propeller	
Propeller diameter (mm)	2 000			2 150	
L, nominal stem length (mm)	2 840/2 900			2 940/3 000	
Weight, dry (kg)*	15 500			16 500	
Nominal input speed	750-2 000 rpm			750-2 000 rpm	
Nominal input power **	Max. 1 420 kW			Max. 1 420 kW	
Bollard pull range	Up to 45 metric tons per two (2) units			-	

US 205	Ducted FP/CP propeller		Open propeller		CRP
Propeller diameter (mm)	2 300	2 400	Max. 2 700		Max. 2 700
L, nominal stem length (mm)	3 245	3 305	3 245, 3 305		3 245
Weight, dry (kg)*	17 700	20 000	16 000		20 000
Nominal input speed	750-1800 rpm		750-1800 rpm		
Nominal input power **	Max. 1 800 kW				Max. 1 600 kW
Bollard pull range	Up to 55 metric tons per two (2) units				-

US 255	Ducted FP/CP propeller		Open propeller	
Propeller diameter (mm)	2 600		2 800	
L, nominal stem length (mm)	3 555		3 800	
Weight, dry (kg)*	28 000		29 500	
Nominal input speed	600-1 500 rpm		600-1 500 rpm	
Nominal input power **	Max. 2 420 kW		Max. 2 420 kW	
Bollard pull range	Up to 75 metric tons per two (2) units		-	

US 305	Ducted FP/CP propeller		Open propeller	
Propeller diameter (mm)	2 800		3 000	
L, nominal stem length (mm)	3 970		4 100	
Weight, dry (kg)*	34 700, 39 200		37 000, 41 000	
Nominal input speed	750-1 200 rpm		750-1 200 rpm	
Nominal input power **	Max. 3 050 kW		Max. 3 050 kW	
Bollard pull range	Up to 90 metric tons per two (2) units		-	

NOTES

* Max. dry weight of weld-in installation.

** The power figures on table are for ship assisting harbour tugs driven by diesel engine.

The actual power figures are defined according to the application, prime mover, classification etc.

All data is subject to change without prior notice.



Rolls-Royce

Rolls-Royce Oy Ab
P.O. Box 220, FIN-26101, Finland
Tel: +358 2 83791 Fax: +358 2 8379 4804
Rolls-Royce Marine AS, Dept. Propulsion - Ulstein
Sjøgata 98, N-6065 Ulsteinvik, Norway
Tel: +47 70 01 40 00 Fax: +47 70 01 40 17
www.rolls-royce.com

© 2002 Rolls-Royce plc
Whilst this information is given in good faith, no warranty or representation is given concerning such information, which must not be taken as establishing any contractual or other commitment binding upon Rolls-Royce plc or any of its subsidiary or associated companies.