



DAMEN STAN PATROL® 5009 "P 511"

GENERAL

YARDNUMBER	549601
OWNER	ENAPOR
DATE OF DELIVERY	December 2011
FLAG	Cape Verde
HULL MATERIAL	Steel
WHEELHOUSE MATERIAL	Aluminium
BASIC FUNCTIONS	-Patrol duties -Maritime Safety -Securing economical waters & coastal boundaries -Search and Rescue
CLASSIFICATION	Bureau Veritas I ✳ Hull ● Mach AUT-UMS Light Ship/ Patrol boat , Sea Area 4

DIMENSIONS

LENGTH O.A.	50.02 m
BEAM O.A.	9.40 m
DEPTH AT SIDES	4.30 m
DRAUGHT	3.50 m

TANK CAPACITIES

FUEL OIL	63.10 m ³
FRESH WATER	26.60 m ³
BILGE WATER	2.70 m ³
LUB OIL /DIRTY OILTANK	1.80 m ³
SEWAGE (GREY)	11.70 m ³
SEWAGE (BLACK)	7.00 m ³

PERFORMANCES (TRIALS)

SPEED	23.0 kn.
-------	----------

PROPULSION SYSTEM

MAIN ENGINES	4 x Caterpillar C32
TOTAL POWER	4324 bkW (5800 bhp) 2000-2300 rpm
GEARBOXES	Reintjes WVS 730
PROPELLERS	Fixed pitch propellers
BOW THRUSTER	2 x 100 bkW

AUXILIARY EQUIPMENT

MAIN GENERATOR SETS	2 x Generator sets, 107 kVA each
NETWORK	230/400V – 50 Hz
FIRE FIGHTING (INTERNAL)	Fixed Fi-Fi system in engine room (Novec)
BILGE WATER SEPERATOR	Facet, CPS-2.5 MK II
FUEL SEPERATOR	Westfalia OTC-2
FIRE FIGHTING	External fire fighting system 120 m ³ /h

DECK LAY-OUT

ANCHOR	2x 270 kg, High holding power, Pool - TW
ANCHOR WINCH	Electrical driven
HYDRAULIC CRANE	Heila HLM 3-2S
SLIPWAY IN AFT SHIP	Hydraulic operated transom door
DAUGHTER CRAFT	1 x 7.5 m MST RIB with inboard diesel / waterjet, speed 30 kn. with a crew of 6 persons
LIFE RAFTS	6 x 50 persons

ACCOMMODATION

CREW CABINS	1 Commander's cabin at maindeck 3 cabins for 1 Officer at maindeck 3 cabins for 2 Officer's below the maindeck 4 cabins for 2 crew below maindeck
AIR CONDITIONING	Air Conditioning in wheelhouse and accommodation

NAUTICAL AND COMMUNICATION EQUIPMENT

SEARCHLIGHT	
MAGNETIC COMPASS	
GYRO COMPASS	
AUTO PILOT	
DGPS	
ELECTRONIC CHART SYSTEM	
RADAR X2, (X + S BAND)	
ECHO SOUNDER	
SPEEDLOG	
SAR FINDER	
AIS	
INMARSAT - C	
INTERCOM/ LAUDHAILER	
CCTV	
TELEPHONE EXCHANGE	
COMMUNICATION	

According GMDSS A2

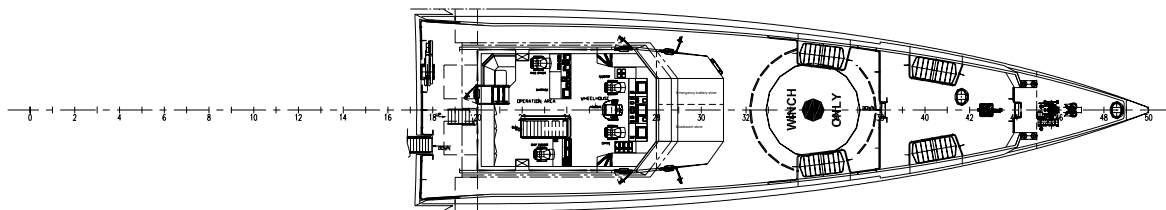
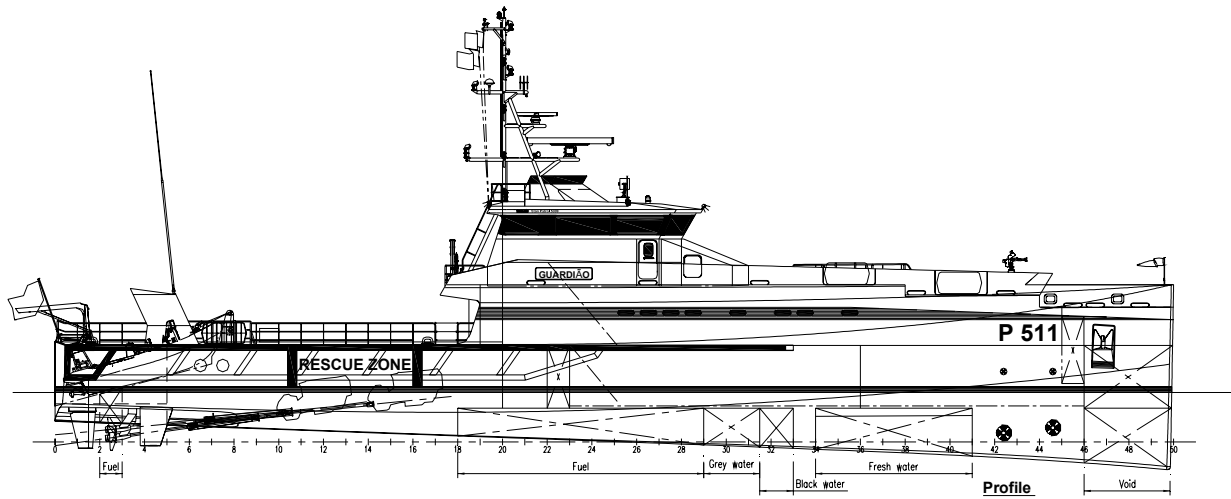

Bridgedeck

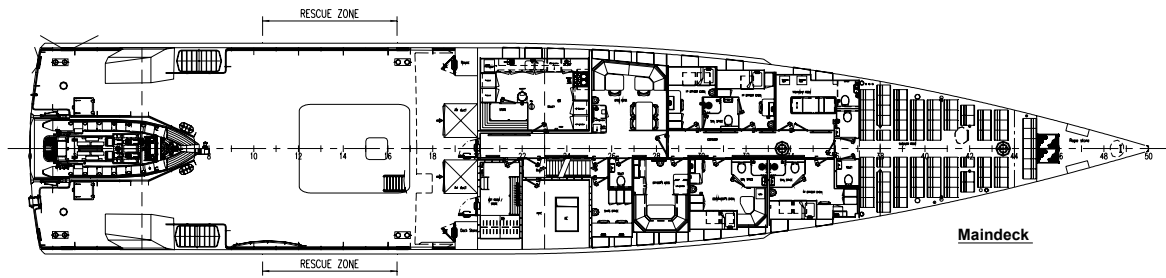

Maindeck

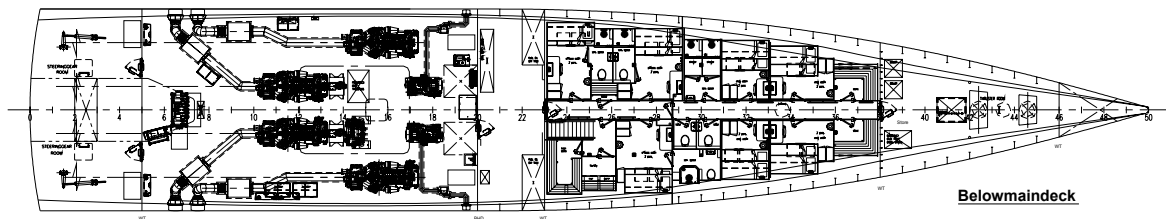

Belowmaindeck

DAMEN STAN PATROL® 5009

"P 511"

DAMEN

DAMEN SHIPYARDS GORINCHEM

Member of the DAMEN SHIPYARDS GROUP



Industrieterrein Avelingen West 20
4202 MS Gorinchem

P.O. Box 1
4200 AA Gorinchem
The Netherlands

phone +31 (0)183 63 99 11
fax +31 (0)183 63 21 89

info@damen.nl
www.damen.nl