



DAMEN STAN PATROL[®] 5509

"SEA AXE"

GENERAL

HULL MATERIAL
SUPERSTRUCTURE
BASIC FUNCTIONS

Steel
Aluminium
Patrol duties, maritime safety,
securing economical waters, search
and rescue
Bureau Veritas
I ✕ Hull •Mach AUT-UMS
Light Ship, Patrol boat
Sea Area 4

CLASSIFICATION

DIMENSIONS

LENGTH O.A. 58.00 m
BEAM O.A. 9.55 m
DEPTH AT SIDES 4.40 m
DRAUGHT MAX 2.90 m

CAPACITIES

FUEL OIL 85.5 m³
FRESH WATER 11.5 m³
BILGE WATER 2.7 m³
SEWAGE 22.5 m³
WATER BALLAST 29.7 m³
CREW 18 - 30 persons

PERFORMANCES

SPEED 25 - 30 knots
RANGE 1,000 nm. at max speed
ENDURANCE 21 days

PROPULSION SYSTEM

MAIN ENGINES 2x MTU
TOTAL POWER 5000 – 10000 bkW
GEARBOXES 2x Reintjes / ZF
PROPULSION 2x Controllable propellers
BOWTHRUSTERS 2x 75 bkW

ELECTRICAL EQUIPMENT

NETWORK 24V d.c., 230/400V, 50 Hz a.c.
GENERATOR SETS 3x 125 ehW, 156.0 kVA
EMERGENCY GENERATOR 1x 36 ehW, 45.0 kVA

DECK LAY-OUT

ANCHOR EQUIPMENT 270 kg, HHP according class
ANCHOR WINCH Electric driven
DAUGHTER CRAFTS 2x 6.5m RIB, 35 knots
DAVIT 2x A-frame davits
CRANE Heila HLM 3-2 S

LIFE SAVING EQUIPMENT

LIFE RAFTS 2x 25 persons
LIFE JACKETS Based on number of persons on board
FIRE EXTINGUISHING Hand operated fire extinguishers. Fixed Fi-Fi
system in engine room (Novac 1230)
EXTERNAL FIRE FIGHTING Water/foam monitor

AUXILIARY EQUIPMENT

STABILIZERS Active system
GENERAL SERVICE PUMPS Electrically driven, 400 V, Azcuc CA 50
ENGINE ROOM VENTILATION 2x 36,000 m³/hr
BILGE WATER SEPERATOR
FUEL SEPERATOR
SEWAGE SYSTEM

ACCOMODATION

BELOW MAIN DECK Cabins for Officer's and cabins for crew
MAIN DECK Commander's cabin, cabins for Officers,
stores, ship office, galley and mess
440,000 BTU

AIR CONDITIONING

NAUTICAL, SURVEILLANCE AND COMMUNICATION EQUIPMENT

SEARCHLIGHT 2x 1000 Watt 230 V
COMPASS Gyro and magnetic
ECHO SOUNDER
RADAR
AIS
GPS/ DGPS
INTERNAL COMMUNICATION Intercom , loudhailer and CCTV system
EXTERNAL COMMUNICATION According GMDSS A3

VARIOUS

Vessel can be delivered with a wide range of armory.

NOTE: SOME ITEMS IN THIS SPECIFICATION ARE OPTIONAL. SPECIFICATION AND GENERAL ARRANGEMENT CAN BE CHANGED WITHOUT NOTICE.

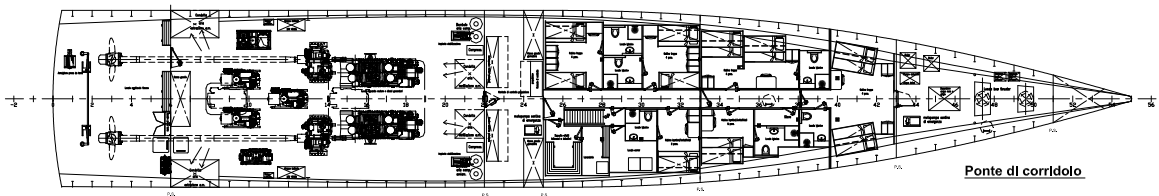
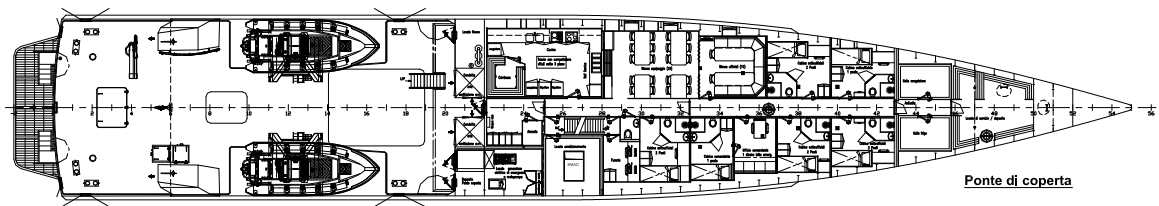
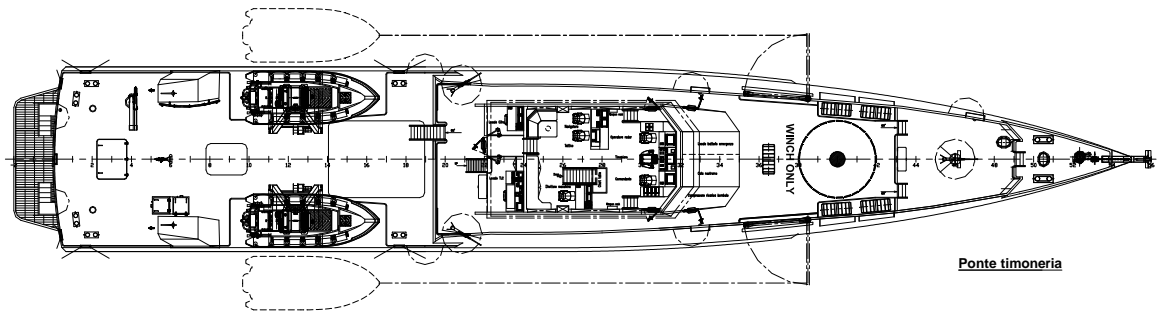
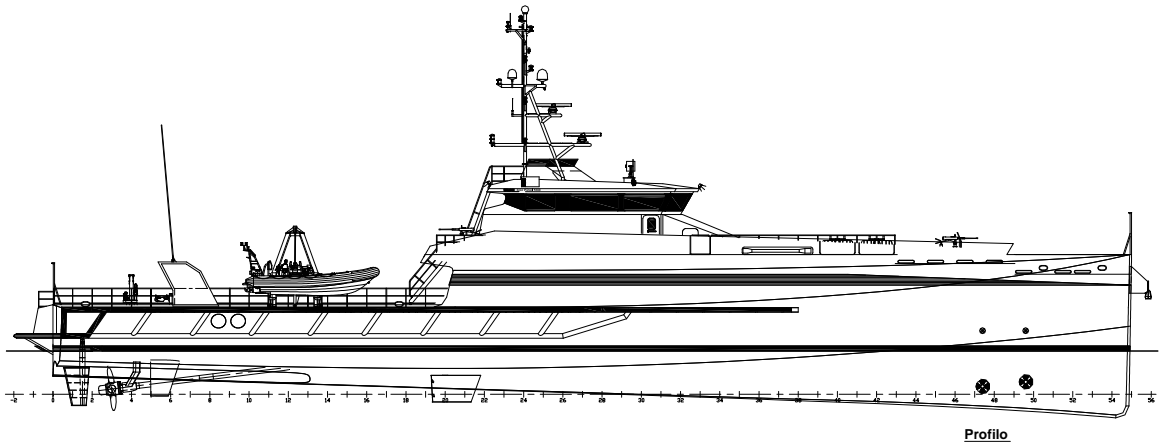

DAMEN STAN PATROL® 5509

"SEA AXE"

DAMEN

DAMEN SHIPYARDS GORINCHEM

Member of the DAMEN SHIPYARDS GROUP



Industrieterrein Avelingen West 20
4202 MS Gorinchem

P.O. Box 1
4200 AA Gorinchem
The Netherlands

phone +31 (0)183 63 99 11
fax +31 (0)183 63 21 89

info@damen.com
www.damen.com