



DAMEN STAN PATROL® 2205 FRP "SEA AXE"

GENERAL

HULL MATERIAL	FRP
SUPERSTRUCTURE	FRP
BASIC FUNCTIONS	Patrol, surveillance and safety duties
CLASSIFICATION	Bureau Veritas I ✪Hull • MACH Special Service/Fast Patrol Boat Sea Area 3

DIMENSIONS

LENGTH O.A.	22.80 m
BEAM O.A.	6.08 m
DEPTH AT SIDES	2.65 m
DRAUGHT MAX	1.50 m

CAPACITIES

FUEL OIL	5.0 m ³
FRESH WATER	1.0 m ³
DIRTY OIL/ BILGE WATER	0.2 m ³
SEWAGE	0.5 m ³
CREW	8 persons

PERFORMANCES

MAXIMUM SPEED	30.0 kn.
RANGE/ ENDURANCE	300 nm. at max. speed

PROPULSION SYSTEM

MAIN ENGINES	2x MTU/Caterpillar
TOTAL POWER	1600 - 1800 kW
GEARBOXES	2x ZF/Reintjes
PROPULSION	2x Fixed pitch propellers

ELECTRICAL EQUIPMENT

NETWORK	24V d.c., 230/400V 50 Hz a.c.
GENERATOR SETS	2x 22.5 kW, 28.0 kVA

DECK LAY-OUT

ANCHOR EQUIPMENT	1x 48 kg HHP with chain and line
FENDERING	Rubber "D" type
SLIPWAY	With small capstan
DAUGHTER CRAFTS	4 m RIB

LIFE SAVING EQUIPMENT

LIFE BUOYS	2
LIFE JACKETS	Based on number of persons on board
LIFE RAFTS	1x 10 persons
FIRE EXTINGUISHING	Hand operated fire extinguishers. Fixed Fi-Fi System in engine room (Aerosol)

AUXILIARY EQUIPMENT

ENGINE ROOM VENTILATION	2x 10,000 m ³ /hr
GENERAL SERVICE PUMPS	Electrically driven, 400V, Azcue CA 50
CATHODIC PROTECTION	

ACCOMODATION

BELOW MAIN DECK	Mess, pantry, toilet, shower, stores and cabins
MAIN DECK	8x motion damped seats
AIR CONDITIONING	120,000 BTU/hr

NAUTICAL, SURVEILLANCE AND COMMUNICATION EQUIPMENT

SEARCHLIGHT	1x 500W, 230V
COMPASS	Magnetic
ECHO SOUNDER	
RADAR	
GPS	
AIS	
VHF	
VHF HAND HELD	
NAVTEX	
MF/HF	

VARIOUS

Vessel can be equipped with light armory.

NOTE: SOME ITEMS IN THIS SPECIFICATION ARE OPTIONAL. SPECIFICATION AND GENERAL ARRANGEMENT CAN BE CHANGED WITH OUT NOTICE.

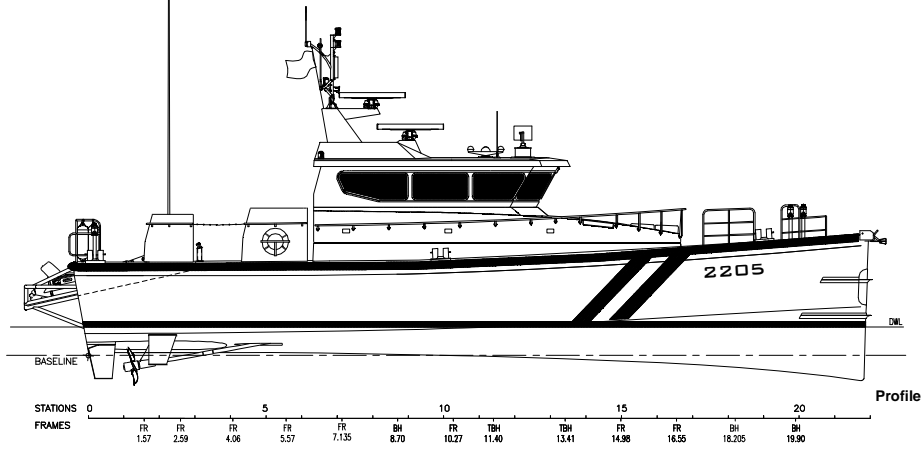

Profile

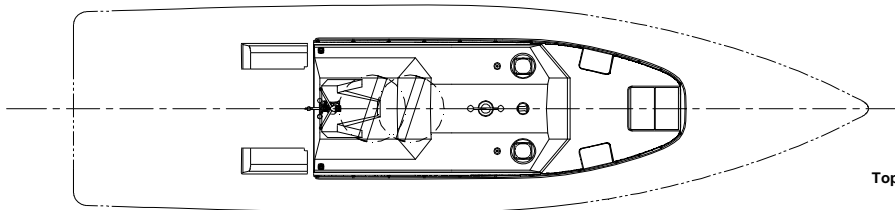

Top of Wheelhouse

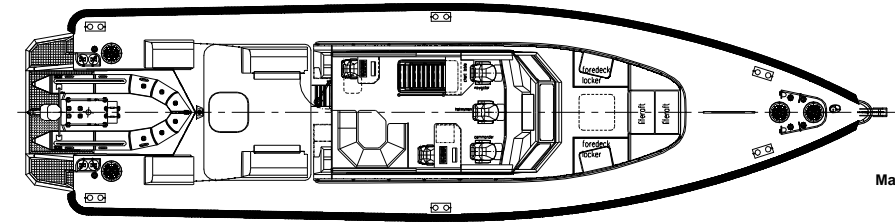

Main Deck

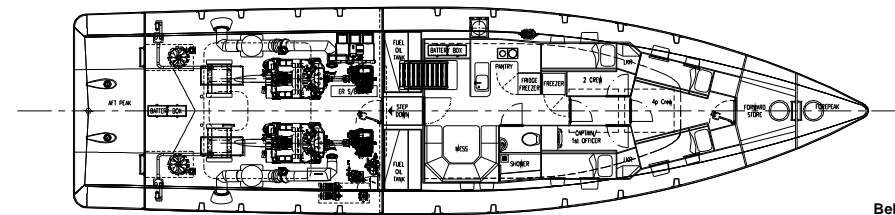

Below Maindeck

DAMEN STAN PATROL® 2205 FRP

"SEA AXE"

DAMEN

DAMEN SHIPYARDS GORINCHEM

Member of the DAMEN SHIPYARDS GROUP



Industrieterrein Avelingen West 20
4202 MS Gorinchem

P.O. Box 1
4200 AA Gorinchem
The Netherlands

phone +31 (0)183 63 99 11
fax +31 (0)183 63 21 89

info@damen.nl
www.damen.nl